

103D UTILITY GAUGE U-CLAMP PANEL MOUNT

Utility gauge for commercial and industrial markets
Chrome case and bezel, copper alloy internals

SPECIFICATIONS

Dial	1 ½" (40 mm), 2" (50 mm), 2 ½" (63 mm), 3 ½" (88 mm)
Case	Chrome plated steel, dry non-fillable (3 ½" = painted steel with plastic, twist-off lens)
Wetted Parts	Copper alloy
Bezel	Chrome plated steel, fixed
Lens	Plastic
Pointer	Black aluminum
Connection	Center back mount with u-clamp 1 ½" dial = ⅛" NPT 2" dial = ⅛" or ¼" NPT 2 ½" dial = ¼" NPT 3 ½" dial = ¼" NPT
Scale	Standard: psi/BAR (x 100 = kPa)
Accuracy	3-2-3% of span, ASME B40.1 Grade B
Ambient Temp	-50° F to 160° F

Design meets or exceeds ASME B40.100 pressure gauge standard.

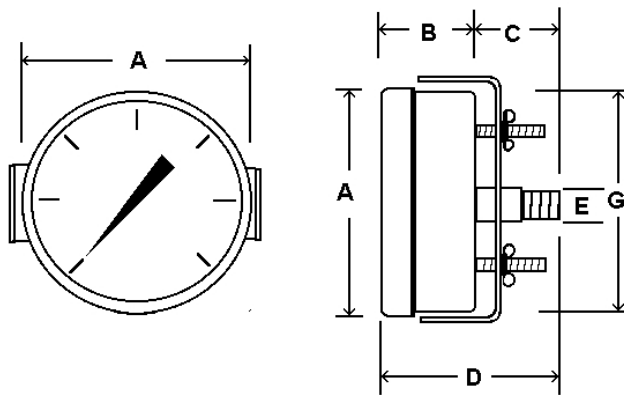

Dial	Unit	A	B	C	D	G	E
1 ½"	In.	1.84"	1.03"	0.63"	1.61"	1.61"	⅛" NPT
	mm	47	26	16	41	41	
2"	In.	2.31"	1.18"	0.73"	1.84"	2.04"	⅛" or ¼" NPT
	mm	59	30	19	47	52	
2 ½"	In.	2.68"	1.12"	0.76"	1.87"	2.44"	¼" NPT
	mm	68	28	19	48	62	
3 ½"	In.	3.98"	1.23"	0.67"	2.02"	3.59"	¼" NPT
	mm	101	31	17	51	91	



AVAILABLE OPTIONS*

- Certificate of Accuracy, NIST traceable
- Custom Dial
- Anti-Vibration Movement, see page 109
- Glass Lens
- Stainless Steel Case
- Cleaned for Oxygen Service
- Special Connection Size
- Protective Rubber Cover, see page 121
- Max/Min Pointer, see page 122

*Lead times/minimums may apply

APPROXIMATE SHIPPING WEIGHTS/ BOX QUANTITIES

Dial Size	Est. Unit Weight	Box Qty
1 ½"	0.20 lbs (0.10 kg)	100
2"	0.30 lbs (0.14 kg)	100
2 ½"	0.35 lbs (0.18 kg)	100
3 ½"	0.60 lbs (0.26 kg)	50